

# Canopy dimensions REPORT

**Test report ref. number: CCC-NK0220**

Name: **Icepeak X-One** Place: **Le Chables**  
 Size: **24** Date of measurement: **10.03.2020**  
 Maximum load [kg]: **112** Inspector: **Tim Rochas**  
 Serial number: **IPXI2224V1**

Manufacturer name: **Niviuk gliders / Air Games**

Paragliders permitted in FAI Category 1 Cross-Country events 2018 Edition Revision 1,9

Street: **Carrer del Ter 6 - nave D**  
 Post code / place: **17165 La Cellera de Ter - Girona**  
 Country: **(Spain)**  
 Tel: **+34 972 422 878**

## Canopy dimensions

|                   | RIB nb from center | Measure mm | Tension | Tolerances |
|-------------------|--------------------|------------|---------|------------|
| Full Span         |                    | 13519.4    | 5 daN   | 2%         |
| 1/2 Trailing Edge |                    | 6931.4     | 5 daN   | 1%         |
| Chord A           | 1                  | 2153       | 1 daN   | 1%         |
| Chord B           | 25                 | 1870.8     | 1 daN   | 1%         |

| Aspect ratio                   |
|--------------------------------|
| 4*span / (chord A+2.5*Chord B) |
| 7.92                           |

| Nbr cells (total) |
|-------------------|
| 115               |

| Scale factor / size 20 |
|------------------------|
| 1.0787                 |

## Chord lenght, inlet position, tabs position measured from trailing edge.

| First fully lined RIB of group 1 (from center) |        |          |         |            |
|--|--------|----------|---------|------------|
|  | Rib n° | Distance | Tension | Tolerances |
| Chord  | 3      | 2130.5   | 1 daN   | +/-10mm    |
| Top of inlet                                   | 3      | 2051.2   | 5 daN   | +/-10mm    |
| Bottom of inlet                                | 3      | 2032.9   | 5 daN   | +/-10mm    |
| Tab Aa   | 3      | 1858.3   | 5 daN   | +/-10mm    |
| Tab Ab   | 3      | 1716.2   | 5 daN   | +/-10mm    |
| Tab B  | 3      | 920.9    | 5 daN   | +/-10mm    |
| Tab C  | 3      | 688.8    | 5 daN   | +/-10mm    |

| First fully lined RIB of group 2 (from center) |        |          |         |            |
|--|--------|----------|---------|------------|
|  | Rib n° | Distance | Tension | Tolerances |
| Chord  | 23     | 1915.7   | 1 daN   | +/-10mm    |
| Top of inlet                                   | 23     | 1840.9   | 5 daN   | +/-10mm    |
| Bottom of inlet                                | 23     | 1820.6   | 5 daN   | +/-10mm    |
| Tab Aa   | 23     | 1673.2   | 5 daN   | +/-10mm    |
| Tab Ab   | 23     | 1538.5   | 5 daN   | +/-10mm    |
| Tab B  | 23     | 815.4    | 5 daN   | +/-10mm    |

| Last lined rib (stabilo) (from center) |        |          |         |            |
|--|--------|----------|---------|------------|
|  | Rib n° | Distance | Tension | Tolerances |
| Chord                                  | 56     | 548.8    | 1 daN   | +/-10mm    |
| Tab A                                  | 56     | 464.7    | 5 daN   | +/-10mm    |
| Tab B                                  | 56     | 314.2    | 5 daN   | +/-10mm    |

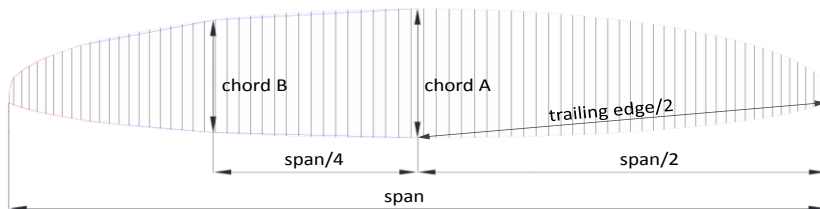

Span /2            6759.7  
 Span /4            3379.85

### Line plan IP X-One

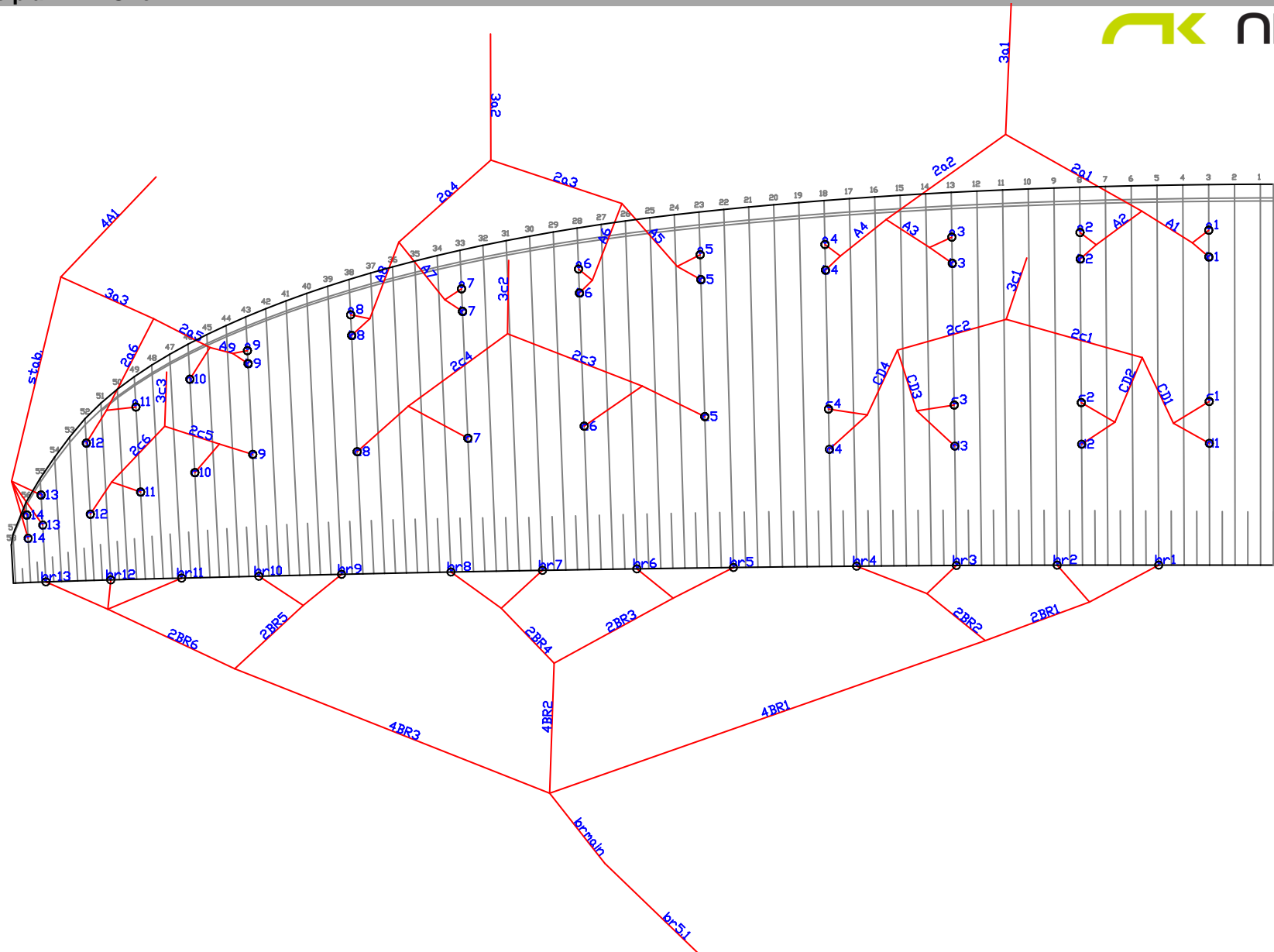



Manufacture: **Niviuk gliders**  
 Glider: **Icepeak X-One 24**

S/N: **IPXI2224V1**

Done by: **Tim Rochas**

date: **10.03.2020**

## Line measurement

Lines measurements with risers in mm under 5kg (from wing to bottom of risers)

| Name | Manual | Sample mesured | Dif | Name | Manual | Sample mesured | Dif | Name | Manual | Sample mesured | Dif | Name | Manual | Sample mesured | Dif |
|------|--------|----------------|-----|------|--------|----------------|-----|------|--------|----------------|-----|------|--------|----------------|-----|
| a1   | 8390   | 8393           | 3   | b1   | 8372   | 8375           | 3   | c1   | 8390   | 8391           | 1   | d1   | 8494   | 8495           | 1   |
| a2   | 8255   | 8259           | 4   | b2   | 8235   | 8240           | 5   | c2   | 8219   | 8222           | 3   | d2   | 8324   | 8321           | -3  |
| a3   | 8224   | 8227           | 3   | b3   | 8205   | 8208           | 3   | c3   | 8189   | 8188           | -1  | d3   | 8292   | 8293           | 1   |
| a4   | 8273   | 8280           | 7   | b4   | 8254   | 8259           | 5   | c4   | 8282   | 8276           | -6  | d4   | 8378   | 8375           | -3  |
| a5   | 8161   | 8168           | 7   | b5   | 8139   | 8147           | 8   | c5   | 8161   | 8165           | 4   |      |        |                |     |
| a6   | 7982   | 7990           | 8   | b6   | 7960   | 7968           | 8   | c6   | 7962   | 7966           | 4   |      |        |                |     |
| a7   | 7875   | 7881           | 6   | b7   | 7853   | 7858           | 5   | c7   | 7871   | 7876           | 5   |      |        |                |     |
| a8   | 7857   | 7860           | 3   | b8   | 7841   | 7842           | 1   | c8   | 7906   | 7907           | 1   |      |        |                |     |
| a9   | 7611   | 7617           | 6   | b9   | 7596   | 7601           | 5   | c9   | 7638   | 7640           | 2   |      |        |                |     |
| a10  | 7524   | 7534           | 10  |      |        |                |     | c10  | 7530   | 7537           | 7   |      |        |                |     |
| a11  | 7466   | 7475           | 9   |      |        |                |     | c11  | 7478   | 7486           | 8   |      |        |                |     |
| a12  | 7479   | 7487           | 8   |      |        |                |     | c12  | 7501   | 7504           | 3   |      |        |                |     |
| a13  | 7373   | 7382           | 9   |      |        |                |     | c13  | 7382   | 7386           | 4   |      |        |                |     |
| a14  | 7363   | 7369           | 6   |      |        |                |     | c14  | 7388   | 7395           | 7   |      |        |                |     |

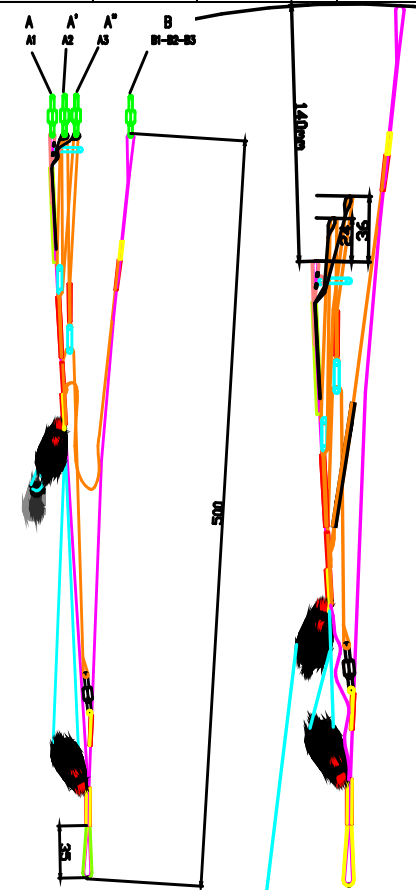

Risers measurements with carabiner in mm under 5kg (from bottom of risers to bottom of lines)

| Risers Manual        |     |
|----------------------|-----|
| Position 1 (neutral) |     |
| A                    | 521 |
| A'                   | 522 |
| A''                  | 523 |
| B                    | 524 |
| Δtrim (A-B)          | -3  |
| Position accélérée   |     |
| A                    | 372 |
| A'                   | 396 |
| A''                  | 407 |
| B                    | 516 |
| Δaccel (B-A)         | 144 |
| Total speed range    | 141 |